

Waterford Waterway 2018 Final 2,4-D/endothall Spot-Treatment Application Areas									
Site	Location	Preliminary Acres	Final Acres	Ave Depth (ft)	Total Volume (acre-feet)	Application Area Dose			
						2,4-D PPM ae	Liquid Amine (gallons)	Endothall PPM ai	Aquathol K (gallons)
A-18	Tichigan Lake	3.3	3.3	2.8	9.2	1.15	7.6	3.45	20.5
B-18	Tichigan Lake	1.3	1.3	2.0	2.6	1.04	1.9	3.09	5.2
C-18	Elm Island Bay	6.3	6.3	1.8	11.0	1.14	9.0	3.43	24.3
D-18	Tichigan Lake	2.2	removed	-	-	-	-	-	-
E-18	Tichigan Lake	23.6	25.0	4.5	106.2	3.00	227.9	1.50	102.4
F-18	Tichigan Lake	5.2	removed	-	-	-	-	-	-
G-18	Tichigan Lake	5.9	removed	-	-	-	-	-	-
H-18	Tichigan Lake	0.6	removed	-	-	-	-	-	-
I-18	Fox River	2.8	removed	-	-	-	-	-	-
K-18	Buena Lake	4.4	removed	-	-	-	-	-	-
L-18	Waterford Lake	2.5	removed	-	-	-	-	-	-
Total		58.0	35.9		129.1		246.4		152.4

Waterford Waterway 2018 Final Diquat & Endothall Application Areas								
Site	Location	Preliminary Acres	Final Acres	Ave Depth (ft)	Total Volume (acre-feet)	Aquastrike	Diquat	Endothall
						(gallon/acre-ft)	(ppm cation)	(ppm ai)
J-18	Fox River	10.3	removed	-	-	-	-	-

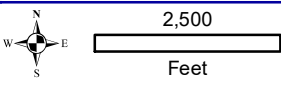
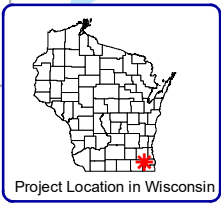

Onterra LLC
 Lake Management Planning
 815 Prosper Road
 De Pere, WI 54115
 920.338.8860
 www.onterra-eco.com

Sources:
 Roads and Hynds: WDNR
 Plant Survey: Onterra, 2017
 Map Date: May 14, 2018 - TWH
 Filename:
 Waterford_EWMSpotTreat_T2018_Perml.mxd

Legend

- 2018 Proposed Herbicide Application Areas
- 2018 Final Herbicide Application Areas
- Public Access
- Waterford Dam

Map 9
 Waterford Waterway
 Racine County, Wisconsin
**2018 Final AIS
 Treatment Strategy**